

F | E | D | C | B | A

4

4

3

3

2

2

1

1

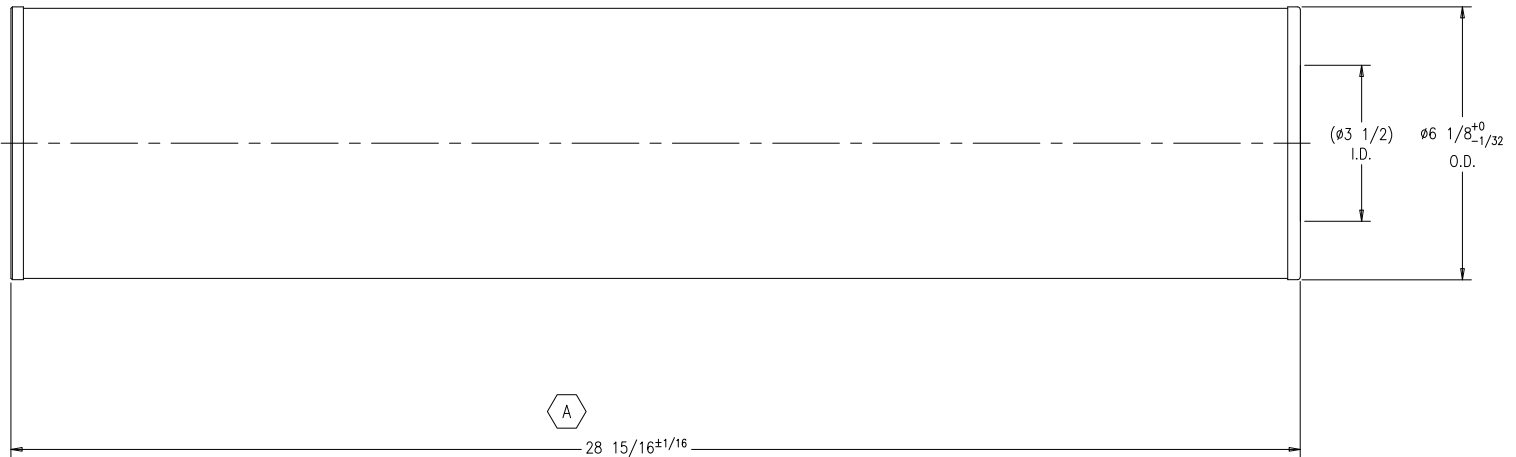

MATERIALS OF CONSTRUCTION

1. MOLDED URETHANE ENDS
2. CORROSION RESISTANT CENTERTUBE
3. BUNA N GASKETS
4. PLEATED SYNTHETIC MEDIA WRAPPED WITH FIBERGLASS COALESCER MEDIA
5. 250°F MAX. TEMPERATURE



PARTICULATE REMOVAL EFFICIENCY: BETA 4 = 200
 MOISTURE REMOVAL = 5% TO LESS THAN 150 PPM
 IN A SINGLE PASS.

B	ADDED MATERIALS OF CONSTRUCTION AND SPECS	DAN	7/11/12	LTH
A	LENGTH WAS 28 11/16"	LTH	6/03	LTH
REV	DESCRIPTION	BY	DATE	APP

THE INFORMATION AND DATA CONTAINED HEREIN CONFORMS TO ASME Y14.5-M 1994

DRAWING STATUS

PRODUCTION

THIS DOCUMENT CONTAINS PROPRIETARY INFORMATION AND SUCH INFORMATION MAY NOT BE DISCLOSED TO OTHERS OR USED FOR ANY PURPOSE WITHOUT WRITTEN PERMISSION FROM THE HILLIARD CORP. © COPYRIGHT THE HILLIARD CORPORATION, ALL RIGHTS RESERVED. MAKE FROM	UNLESS OTHERWISE SPECIFIED FINISH: <input checked="" type="checkbox"/> MACHINE UNLESS OTHERWISE SPECIFIED BREAK CORNERS: .015 MAX	THE HILLIARD CORPORATION 100 WEST FOURTH STREET ELMSFA, NEW YORK 14902 UNLESS OTHERWISE SPECIFIED: DIMENSIONS ARE IN INCHES () DIMENSIONS IN MM	DRAWN: GF DATE: 06/28/00	TITLE HC628-01-CSP COALESCER CARTRIDGE
	UNLESS OTHERWISE SPECIFIED: FRACTIONAL DIMENSIONS - ± 1/16 DECIMAL DIMENSIONS - .001 - ± .015 ANGLES - ± 2°		CHECKED: GLF DATE: 06/28/00	
	UNLESS OTHERWISE SPECIFIED: FRACTIONAL DIMENSIONS - ± 1/16 DECIMAL DIMENSIONS - .001 - ± .015 ANGLES - ± 2°		APPROVED: GLF DATE: 06/28/00	
	UNLESS OTHERWISE SPECIFIED: FRACTIONAL DIMENSIONS - ± 1/16 DECIMAL DIMENSIONS - .001 - ± .015 ANGLES - ± 2°		SIMILAR TO: SCALE: 1:2	
			SHEET 1 OF 1 DD-700-103	C

F | E | D | C | B | A